



## Buckinghamshire Local Access Forum agenda

Date: Wednesday 2 November 2022

Time: 10.00 am

Venue: The Paralympic Room, Buckinghamshire Council, Gatehouse Road, HP19 8FF

### Membership:

Mr D Briggs (NFU, CLA, farming, Chairman of the Bucks CLA, Chairman of the Chilterns LEADER) (Vice-Chairman), Cllr S Broadbent, Mr G Casperz (Disabled Ramblers), Mr A Clark (Chiltern Society), Mr N Harris (National Trust), Ms A Heath (British Horse Society), Mr C Hurworth (Trail Riders' Fellowship and MPV users), Mr R Jennings (Cycling UK), Mr R Johnson (Ramblers Association), Mr A Lambourne (Parish Councils), Mr R Pushman (Bucks Conservation Trust & Bucks Heritage Champion) (Chairman), Mr G Thomas (Independent), Cllr A Turner and Mr B Worrell (British Driving Society Beds, Bucks and Herts)

**There will be a 10-minute break at 11am**

<b>Agenda Item</b>	<b>Page No</b>
<b>1 Apologies</b>	
<b>2 Declarations of Interest</b>	
<b>3 Matters Arising</b> <ul style="list-style-type: none"><li>• Minutes of the previous meeting</li><li>• Chairman's retirement</li></ul>	
<b>4 Local Cycling &amp; Walking Infrastructure Plans &amp; High Wycombe 2050 Transport Strategy Consultations</b> Hannah Bishop, Head of Transport Strategy and Funding.	<b>3 - 4</b>
<b>5 Rights of Way Group Update</b> Helen Francis, Senior Definitive Map Officer; Jonathan Clark, Strategic Access Officer; and Joanne Taylor, Rights of Way Operations Team Leader.	<b>5 - 20</b>
<b>6 LAF Members' Report</b>	<b>21 - 30</b>

**7 Any Other Business**

**8 Dates of the Next Meetings**

10am Paralympic Room, The Gateway AYLESBURY HP19 8FF 1st March 2023; 12th July 2023, 1st November 2023.

If you would like to attend a meeting, but need extra help to do so, for example because of a disability, please contact us as early as possible, so that we can try to put the right support in place.

For further information please contact Harry Thomas by email at [democracy@buckinghamshire.gov.uk](mailto:democracy@buckinghamshire.gov.uk).



**BUCKINGHAMSHIRE  
LOCAL ACCESS FORUM**

# Report

---

## AGENDA ITEM 4

**Date:** 2<sup>nd</sup> November 2022

**Title:** High Wycombe 2050 Transport Strategy and LCWIP Consultation

**Author:** Hannah Joyce, *Head of Transport Strategy and Funding*; & Jonathan Fuller, *Senior Transport Strategy Officer*.

**Contact Officer:** Harry Thomas [01296 585234]

The Council are consulting on the following two draft transport plans for High Wycombe, which are being developed through local engagement.

### 1. High Wycombe 2050 Transport Strategy

This sets the ambition for the town's transport system and consists of:

- a vision statement - *"By 2050, High Wycombe will be among the best connected and most innovative towns in the Thames Valley, where all journeys, from start to finish, are low emission, seamless, and safe for everyone"*.
- 3 'Connecting' themes [*locally; regionally; green spaces*], each with key outcomes.
- 26 transport schemes across 6 categories: (1) *walking and cycling*; 2) *public transport*, 3) *shared and new mobility*, 4) *highways and congestion management*, 5) *land-use, planning and parking*; and 6) *behavioural change*.

### 2. High Wycombe Local Cycling and Walking Infrastructure Plan (LCWIP)

This is a supporting plan to the draft High Wycombe 2050 Transport Strategy, which aims to recommend ways to make cycling and walking in the High Wycombe area safe, accessible and attractive for all users. It consists of:

- 5 concepts that identify interventions to improve cycling and walking networks: 1) *walkable core*; 2) *main radial routes and key links*; 3) *healthy neighbourhoods*; 4) *wider network and strategic routes*; 5) *a cohesive and connected network*.
- a future walking and cycling network covering High Wycombe and links to surrounding areas. This includes proposals for public right of way improvements, recognising the need to maximise the benefit for all users, including equestrians.

The Local Access Forum are encouraged to participate in and promote the public consultation amongst local networks. The public consultation launched on Friday 14<sup>th</sup> October and closes on Monday 28<sup>th</sup> November. The online survey can be accessed at [buckinghamshire.gov.uk/HWtravel](http://buckinghamshire.gov.uk/HWtravel). Printed copies of the plans and survey are available

at High Wycombe Library. Daytime drop-in sessions are being held on Saturday 5<sup>th</sup> November [Eden Shopping Centre] and Friday 18<sup>th</sup> November [High Wycombe Library].



**BUCKINGHAMSHIRE  
LOCAL ACCESS FORUM**

# Report

**AGENDA ITEM 5**

**Date:** 2<sup>nd</sup> November 2022

**Title:** Rights of Way Group update

**A. MATTERS PREVIOUSLY DETERMINED**

1. **Hedgerley** – application to upgrade public footpath No. 14 to public bridleway status based on historical evidence. **Confirmed by Secretary of State with modifications.**
2. **Little Chalfont** - application to record a public footpath around Statters Field off Burton Lane. **Confirmed Secretary of State.**
3. **Chesham** – Application to add a Public Footpath to the Definitive Map between Fair Leas and Asheridge Road. **Order confirmed. CASE CLOSED.**

**B. DEFINITIVE MAP APPLICATIONS TO BE INVESTIGATED (DMMO)**

All Definitive Map Modification applications are dealt with in chronological order of receipt. However, we will prioritize certain applications under the following circumstances:

Summary:

	2015	2016	2017	2018	2019	2020	2021	2022
Applications received for Definitive Map Modification Orders	2	14	4	4	5	12	12	7
Application determined (accepted or rejected)					1	1 determined		5 (being prepared for determination)
Applications completed (order confirmed or not confirmed)					1	1	0	3

No data collected

Applications for Definitive Map Modification Orders	
Apps. waiting to be investigated	46
Apps. under investigation	8
Orders waiting to be determined by PINS	0

- I. The evidence in support (either fully or in part) of the application is that of User Evidence
- II. There is a threat of development affecting the claimed route
- III. If the evidence in support of the application is shared with another application within the chronological list and it would be efficient to investigate the applications concurrently

1. **Chepping Wycombe** – application to record route between public footpath No. 14 and No. 15 Parish of Chepping Wycombe. **Application dated 14 September 2015. Investigation not started; discussions are ongoing with developer regarding a potential Creation Agreement.**
2. **Marlow** – application to record a public footpath from Cromwell Gardens to New Court. **Application dated 15 January 2016. Decision report being prepared.**
3. **Wooburn** – application to upgrade Public Footpath No. 3 between Princes Road Groves Close to byway open to all traffic. **Application dated 26 February 2016. Decision report being prepared.**
4. **Hazlemere** - application to record various routes in the field adjacent to Public Footpath No. 8 and Public Bridleway No. 6, Parish of Hazlemere as Public Footpaths. **Application dated 23 April 2016. Decision report being prepared.**
5. **Leckhampstead** - Application to upgrade Public Footpath No. 5 (part) to Public Bridleway and add a route which connects with No.5 as Public Bridleway. **Application dated 21 June 2016. Decision report being prepared.**
6. **High Wycombe** – Application to add a Public Footpath to the Definitive Map between Pinewood Road and Public Footpath No. 93. **Application received 3 October 2017. Decision report prepared. Send off comments.**
7. **Stokenchurch** - Application to add routes to the Definitive Map at East Wood, Stokenchurch. **Under investigation.**

8. **Penn** – Application to add a route to the Definitive Map between Public Footpath No. 36 and No. 44. **Application received 19 December 2017. Under investigation.**
9. **Whitchurch** – 3 new applications received to add footpaths to the Definitive Map and Statement – Awaiting acknowledgement and addition to the register of applications.
10. **Whaddon** – application to add a Public Footpath to the Definitive Map between Whaddon Hall and Public Footpath No.6. **Application received 21 December 2018.**
11. **Buckingham** – application to add a Public Bridleway to the Definitive Map following the dismantled railway walk from the A421 to Tingewick Road. **Application dated 14 May 2019.**
12. **Chalfont St Peter** – application to add a Public Footpath to the Definitive Map at Windmill Farm connecting Public Footpath No 19 with Footpath no 55. **Application dated 17 July 2019.**
13. **Chesham** – application to add various routes south of Nashleigh Hill to the Definitive Map connecting with Public Footpath nos. 117, 37 and 67. **Application dated 27 August 2019.**
14. **Chesham** – application to add two routes to the Definitive Map from Lye Green Road connecting with footpath 37. **Application dated 27 August 2019.**
15. **Quainton** – application to upgrade public footpath No. 4 to public bridleway status. **Application dated 21 October 2014. Investigation not started.**
16. **Bledlow** – application to investigate the alignment of public footpath No. 52. **Application dated 19 December 2013. Investigation not started.**
17. **Hedgerley** – application to upgrade public footpath No. 11 and No. 12 to public bridleway status. **Application dated 25 June 2015. Investigation not started.**
18. **Whaddon** – application to modify the alignment of Public Footpath No. 6. **Application dated 4 February 2016. Investigation not started.**
19. **Lillingstone Dayrell** – application to upgrade Public Footpath No.1 to restricted byway status. **Application dated 15 February 2016.**
20. **Lillingstone Dayrell** – application to upgrade Public Footpath No. 2 to public bridleway status. **Application dated 15 February 2016.**
21. **Chenies** application to add Hollaway Road to the Definitive Map and Statement as a byway open to all traffic. **Application dated 29 February 2016.**
22. **Leckhampstead** – application to upgrade Public Footpath No. 13 and 18 to Public Bridleway and add a route as Public Bridleway. **Application dated 26 May 2016.**

23. **Water Stratford** – application to add a claimed bridleway to the Definitive Map and Statement, Parish of Water Stratford **Application received 27/03/2017.**
24. **Little Missenden** - application to upgrade bridleway No. 42 and bridleway No. 29 to restricted byway. **Application received 17/01/2020.**
25. **Little Missenden** - application to upgrade bridleway No. 26 to restricted byway. **Application received 19/02/2020.**
26. **Little Missenden** - application to upgrade bridleway No. 24 to restricted byway. **Application received 07/03/2020.**
27. **Little Missenden** – application to upgrade bridleway No. 25 to restricted byway. **Application received 15/03/2020.**
28. **Water Stratford** – application to add a claimed bridleway to the Definitive Map and Statement. **Application received 1/05/2020.**
29. **Chesham** – application to add a footpath between Hill Farm Road and Pump Lane to the Definitive Map and Statement. **Application received 27/01/2020.**
30. **Denham** – application to add public footpath from Priory Close to Alderbourne Field. **Application received 23/10/2019.**
31. **Waddesdon** – application to upgrade a footpath and claim public bridleway through Eythrope Park. **Application received 7/12/2020.**
32. **Dinton with Ford and Upton** – application to add public footpath between Burgess Lane and footpath No. 53. **Application received 21/12/2020.**
33. **Dinton with Ford and Upton** – application to add footpath between Watery Lane and Moreton. **Application received 21/12/2020.**
34. **Great Marlow** – application to add public footpath around perimeter of Wycombe Air Park – **Application received 21/12/2020.**
35. **Marlow** – application to add public footpath off Liston Road. **Application received 20/12/2020.**
36. **Little Missenden** – application to add public footpath from Parish Piece to Watchet Lane. **Application received 03/03/2021.**
37. **Radnage** – Application to add Public Bridleway from Bottle Square Lane to Bowers Lane. **Application Received 17/05/2021**
38. **Chesham** – Claimed Footpath off Pednor Road. **Application received 21/06/2021**
39. **Dinton with Ford and Upton.** Upgrading to a restricted Byway, Water Lane to Marsh Hill Lane. **Application received 9/08/2021**



40. **Dinton with Ford and Upton.** Claimed Restricted Byway and Upgrading to a Restricted Byway, Moreton Road to Moreton Lane. **Application received 9/08/2021**
41. **Stone with Bishopstone and Hartwell and Great and Little Kimble** – application to add public bridleway from Moreton Lane, Bishopstone to Marsh Hill Lane, Great Kimble. **Application received 14/09/2021.**
42. **Stone with Bishopstone and Hartwell** – application to upgrade part of footpath no. 28 to public bridleway – **Application received 14/09/2021.**
43. **Little Marlow** – application to add public footpath around Roach Lane. **Application received on 02/12/2021.**
44. **Little Marlow and Marlow** – application to add public footpath along A404. **Application received on 02/12/2021.**
45. **Little Marlow/Marlow** – application to add public footpath along Crowne Plaza. **Application received on 02/12/2021.**
46. **Little Marlow/Marlow** – application to add public footpaths, west of Westhope. **Application received on 02/12/2021.**
47. **Little Marlow** – application to upgrade footpath no. 20 to public bridleway. **Application received on 02/12/2021.**
48. **Weedon** – application to add public footpath along Northcroft. **Application received on 09/03/2022.**
49. **Latimer** – application to add Restricted Byway from Kiln Lane to Tylers Hill Road. **Application received 22/03/2022.**
50. **Little Missenden** – application to register circular footpath off Stoney Lane. **Application received 25/03/2022.**
51. **North Marston** - application to add public footpath off Quanton Road. **Application received on 19/07/2022.**
52. **Wooburn** – application to add public footpath along River Wye. **Application received on 23/08/2022.**
53. **Longwick-cum-Ilmer** – application to add Public Bridleway from Stockwell Lane to Bridleway No. 14 – **Application received on 21/09/2022.**
54. **Longwick-cum-Ilmer** – application to upgrade Public Bridleway No. 14 to restricted byway. **Application received on 21/09/2022.**

**C. PUBLIC PATH ORDERS (PPO)** – decisions made by officers through their delegated powers.

Summary:

Applications for Public Path Orders	44
Apps. waiting to be investigated	2
Apps. under investigation/Orders made	21
Orders waiting to be determined by PINS	2
Cases closed	2
Awaiting works by applicant	17

1. **Quarrendon** – Application to divert Footpath No. 2. **Order made, awaiting completion of works.**
2. **Dorney** – Creation of footpath. **Awaiting signed creation agreement.**
3. **Weston Turville** – Application to divert Footpath No. 33 – **Order confirmed. Cycle Track Order Made. Objections Received, to be sent to DFT for determination.**
4. **High Wycombe** – Application to extinguish Footpath No. 27. Wycombe District Council planning matter. Order made and confirmed by WDC. **Awaiting developer works before bringing Order into effect.**
5. **Mursley, Swanbourne and Little Horwood** – Application to divert Public Footpaths No. 19, 20 and 27. **To be abandoned. Diverted under Transport for Works Act.**
6. **Shabbington** – Application to divert Footpath No. 5 –**Order revoked. New corrected order made.**
7. **Quarrendon** – Application to divert Footpath No. 3, 4 & 5 – **Order to be made. Footpath 5 added to proposal.**
8. **Stoke Mandeville** – Application to divert Footpaths Nos. 3 and 14 – **Order confirmed. Awaiting works.**
9. **Stewkley** – Application to divert Footpath No. 19. **Order confirmed. Awaiting works to be completed.**
10. **Tingewick** – Application to divert Footpath No. 25. **Confirmed by PINS. Advertised to bring it into effect.**
11. **Hambleton** – Application to divert Footpath No. 44. **Order made. Awaiting works.**
12. **Buckingham** – Application to divert Footpath No. 36. **Order to be confirmed. Awaiting works.**

13. **Waddesdon** - Application to divert Footpath No. 18. **Order confirmed, awaiting works.**
14. **Wexham** - Application to divert Footpath No. 2. **Under investigation.**
15. **Westcott** - Application to divert Footpath No. 30. **Confirmed by Secretary of State. Awaiting works.**
16. **Bierton** - Application to divert Footpath No. 3. **Order confirmed. Awaiting works.**
17. **Cuddington** – Application to divert footpath no 13 – **Order made. Objection received. Referred to Secretary of State.**
18. **Great Missenden** – Application to divert footpath No. 70 – **Order made. Objections received. Awaiting decision from Secretary of State.**
19. **Chalfont St Giles/Chenies** – application to divert bridleway No.43 and 5 – **Order made. Awaiting works.**
20. **Oakley** – application to divert footpath No. 29 – **Order Made. Awaiting works.**
21. **Chalfont St Peter** – diversion of footpath No. 14 – **Order to be made. Objections received.**
22. **Kingsey** – diversion of footpath No. 1 – **Order made. Awaiting works.**
23. **Steeple Claydon** – diversion of footpath No. 6 – **Order confirmed. Awaiting works.**
24. **Stoke Mandeville** – Extinguishment of Footpath No.8 & 10 – **Order confirmed. Awaiting works.**
25. **High Wycombe/Hughenden** – creation agreement off Brands Hill Avenue – **Order to be confirmed.**
26. **Kingsbrook** – Diversion of Footpath No.1 – **Order made. Awaiting works.**
27. **Worminghall** – Diversion of Footpath No.2 – **Order made.**
28. **Maids Moreton** – Diversion of Footpath No.3 – **Under investigation.**
29. **High Wycombe** – footpath creation off Abbey Barn Lane with Berkeley homes – **Agreement created, to be signed.**
30. **Great Horwood** – bridleway to be created off A421 – **Order to be confirmed.**
31. **Brill** – Diversion of Public Bridleway No. 2 – **Order confirmed. CASE CLOSED.**
32. **Lacey Green** – Diversion of Public Footpath No. 48 – **Under investigation.**

33. **High Wycombe** – Diversion of Public Bridleway No. 156 – **Under investigation.**
34. **Biddlesden** – Diversion of Public Bridleway no. 5 – **Order made, to be advertised.**
35. **Chalfont St Peter** – Diversion of Public Footpath no. 35 – **Under investigation.**
36. **Great Missenden** – Diversion of Public Footpath no. FP1(F) – **Under investigation.**
37. **North Marston** – Diversion of Public Footpath no. 18 – **Order made.**
38. **Marsh Gibbon** – East West Rail creation of Footpath No. 5 – **Awaiting signature.**
39. **Stoke Mandeville** – Diversion of Public Footpath No. 16 - **Order to be made.**
40. **Wexham** – Diversion of Public Footpath No. 7 – **Under investigation.**
41. **Worminghall** – Diversion of Public Bridleways 6 and 7 and Bridleway 38 and 39, Oakley – **Investigation not started.**
42. **Swanbourne** – East West Rail creation of public footpath No. 17 – **Under investigation.**
43. **Wendover** – Diversion of Public Footpath No. 18 – **Under investigation.**
44. **Great Missenden** – Diversion of Public Footpath no. 35 – **Investigation not started.**

#### **D. VILLAGE GREEN APPLICATIONS**

Summary:

Applications for Village Greens	
Investigation on hold	1
Under investigation	4

1. **Wooburn** – land off Cherwell Road, Bourne End. **Investigation not started. On Hold.**
2. **High Wycombe** – land off Warren Wood Drive. **Advertised – objections under considerations.**
3. **Princes Risborough** – land at corner of Shootacre Lane and Picts Lane. **Advertised – objections under considerations.**
4. **Chesham** – land in Lye Green. **Public inquiry to be arranged.**
5. **Stoke Hammond** – land at Layton Road. **Public inquiry to be arranged.**

## E. Strategic Access Update

1. HS2 continue to apply for planning permission under the HS2 Act. These drawings generally outline the landscaping, landform, bridges and planting areas. Rights of way are not included, but the maintenance tracks and bridges provide the forerunner to Schedule 4 applications, which in due course, will divert all rights of way impacted by the development. Only one Schedule 4 application has been received so far.
2. Further information has been provided on the 'Buckinghamshire Cycleway' provision running north-west from Wendover, utilising maintenance access tracks seldom used by vehicles. Appendix A illustrates the route between Ellesborough Road and Nash Lee Lane, surfaced with Type 1 stone to dust and 3.3m wide. It's described as a cycleway but will likely be accessible for equestrians. Details of the route's formal status are yet to be confirmed.
3. Further information is also coming to light on the underpass for non-motorised users at the HS2 crossing of the A4010 Risborough Road [Stoke Mandeville] in the vicinity of the Goat Centre. A 3m wide, 2.8m high underpass will link to the former A4010 and be accessible for horses, cyclists and pedestrians. A link is also provided to the Stoke Mandeville Link Road cycleway – see Appendix A.

## F. ROW OPERATIONS UPDATE (Joanne Taylor)

- 1 **The current staff structure** allows for 7 FTE staff this is 1 Rights of Way Team Leader, 3 Area RoW Officers (one vacant post), 2 Assistant RoW Officers and 1 Bridge Structure Inspector. Additionally, we have a part time temporary post covering the capital work programme. Congratulations to Savannah Fradley on her promotion to Rights of Way Officer. Savannah's vacant post as Assistant RoW Officer has been filled full-time by James Dixon. Regrettably the RoW Operations team will be losing Sophie David at the end of December. Sophie has been with the team for 8 years and will be greatly missed. Recruitment for Sophie's replacement is underway.
- 2 **BVPI Rights of Way Condition Survey** – the 5% network survey was carried out over the winter 21/22 and the results are:
  - Percentage of paths rated 'Easy to Use' 73.5%
  - Percentage of structures rated 'Easy to Use' 92.7%
  - Percentage of paths signed from road 92.6%

This winter's 5% survey will be undertaken very shortly, using volunteers and officers, with results available at the March 2023 LAF meeting.

3 Capital projects update: list of recently completed and current Rights of Way capital projects

Route No. & Parish	Works	Stage
Denham Bridleway 52 [DEN/52/1]	Large equestrian bridge replacement	Design Engineer engaged- broken bridge now removed - expressions of interest from contractors received. Draft design to be signed off by consultant.
Chesham FP114 [CHS/114/1]	Resurface 60 M	21/22 Completed
Chartridge BOAT 38A [CRT/38A/1]	Resurface 100 M	21/22 Completed
Chartridge BW 20A [CRT/20A/1]	Level and resurface 150 M	21/22 Completed
Cholesbury-cum-St Leonards BW51 [CSL/51/1]	Insert Channel Drains	21/22 Completed
Gt Marlow BW23 [GMA/23/1]	Level and resurface 150M	21/22 Completed
Taplow BW2 [TAP/2/1]	200-400M of clearance and surface works	21/22 Completed
Wendover Ridgeway [WEN/47/1]	Clearance and resurface works	2022 work BW47 Completed
Marlow - Thames Path	3 sections of surface works on Marlow length	2022 work complete
Vale Bridges	6 – 8m footbridges to replace in AV area	2022 2 structures installed (additional bridges found for 2023)
Chalfont St Giles BW60 [CSG/60/1]	Resurface works	2022 Works completed under badger licence
Wexham FP16 [WEX/16/1]	Replacement Bridge Structure	2022 Works completed
Stoke Poges FP9 [STP/9/1]	Replacement Bridge Structure	Quotations with contractors
Chesham FP135 [CHS/135/1]	Resurfacing	Works underway
Gawcott FP16A – Oxlane Padbury [GAW/16A/1]	8 metre bridge replacement	Completed

- 4 **Berry Hill Footbridge, Taplow Public Footpath [TAP/12/1] – Capital Programme**  
The 37 metre mid-section of Berry Hill footbridge across the Jubilee River in Taplow was removed in December 2021. The structure has been closed to the public since

May 2021 after suffering unforeseen structural deterioration. The design has been finalised. The Council's contractor is currently seeking approval from the Environment Agency (EA), but work will not be undertaken until 2023 as the EA is undertaking its own major works on the Jubilee River this year, and this will impact on the timetable for replacing and reopening Berry Hill Footbridge. Commencement likely to be summer 2023.

**5 Rights of Way revenue works 2022/23 under review**

The priority works on rights of way found in year is currently under review and will depend on budget; projects identified so far, apart from ongoing projects, as outlined above - include bridge replacements for Little Marlow, and surface repair works in Stewkely, Penn, and Denham, and a flight of concrete steps in High Wycombe.

**6 Summer/winter Clearance – work on the summer clearance schedule commenced mid-May 2022 using 2 external contractor teams we carried out an estimated 80km of surface clearance. NB a large percentage of summer clearance on RoW is undertaken by parish councils as part of Parish Devolvement Agreements. Several projects for winter clearance have been identified and where budgets are available work will be issued to contractors over the next few weeks.**

**7 Rejuvenating the route of the Bernwood Jubilee Way [BJW] 61-mile Historic Trail**  
Regrettably this project has been held, due to the very sad news of the death of Her Late Majesty The Queen. It has been possible to rebrand the web pages for the route, as per the link below and waymarking of the route has also been undertaken.  
<https://www.buckinghamshire.gov.uk/parking-roads-and-transport/cycling-and-walking/walking-and-cycling-routes/walking-and-cycling-route-map/bernwood-jubilee-way-walking-routes/>.

**8 The Ridgeway 50 years – Celebrating 50 years of the National Trail in 2023.**

The Ridgeway Board invites everyone to enjoy events along the Trail throughout 2023, to discover and celebrate the history, myths and memories – please visit the National Trail web pages here:

[https://www.nationaltrail.co.uk/en\\_GB/ridgeway\\_anniversary2023/](https://www.nationaltrail.co.uk/en_GB/ridgeway_anniversary2023/)

There will be a celebration event at Coombe Hill Wendover in September 2023.

**9 Summary of Maintenance – see APPENDIX B.**

This page is intentionally left blank



## HS2 - Bucks Cycleway through Wendover



[MAS = Maintenance Access Strip]

## HS2 - A4010 Risborough Road Underpass

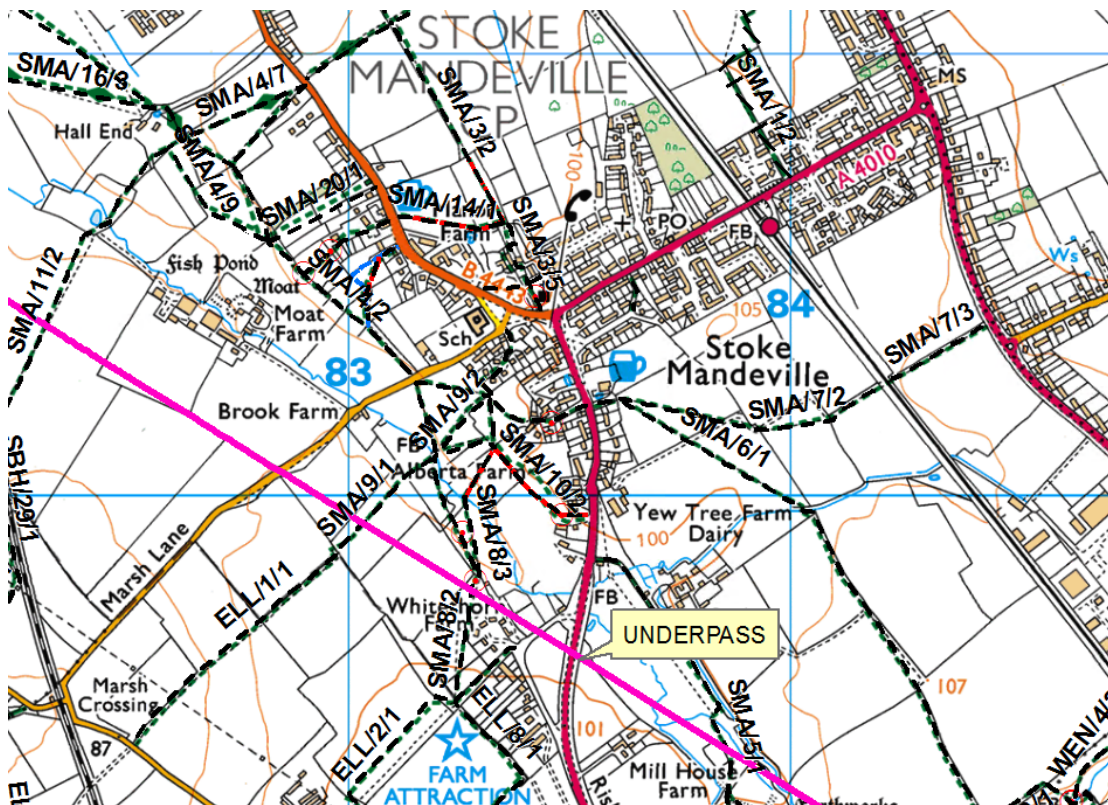

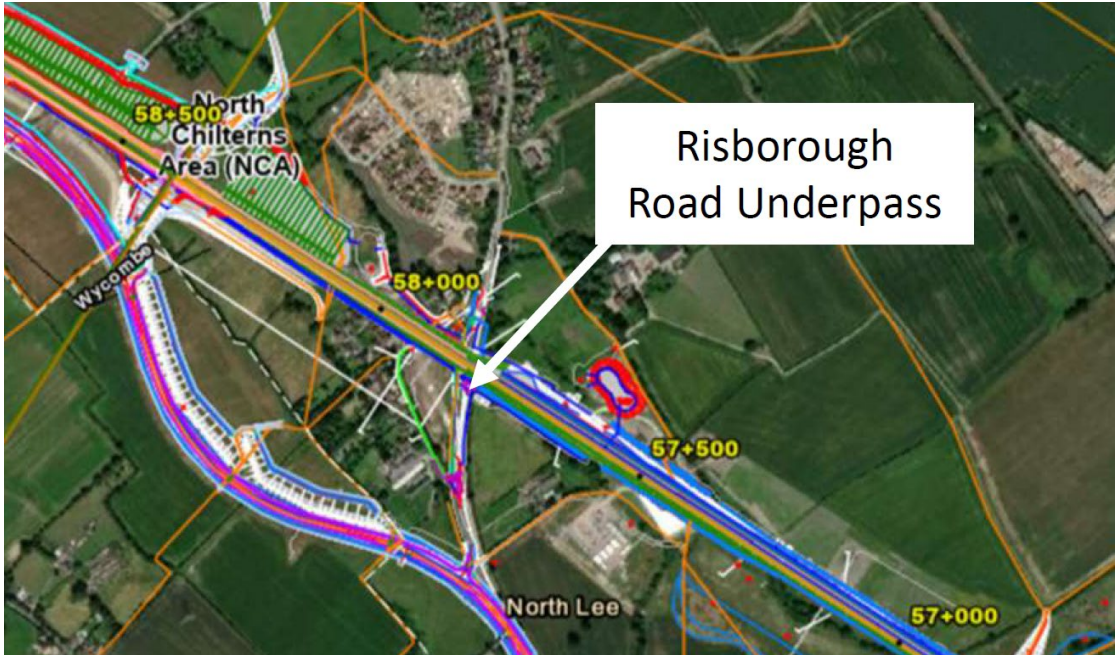

**Buckinghamshire Council - Rights of Way  
Summary of Maintenance Carried Out  
Between 1/04/20 and 19/10/22**

TYPE	DESCRIPTION	Aprl 20- Mar21	1 Aprl21-Mar22	1 Aprl22-Oct22
Alignment	Path Off Line - resolved issue	19	33	8
Clearance	Clearance - carried out-jobs/km	120km/345	120km/450	80km/160
Bridge	Installed or repaired	81	65	45
Finger/post	Installed or repaired	119	187	80
Fly Tipping	Fly Tipping - removed	38	47	14
Gate	Gate repaired or installed	79	163	60
Intimidation+animal/per	Intimidation - resolved	35	25	12
Intimidating sign	Misleading Sign - removed	28	26	6
Obstruction - resolved	Barbed wire	22	36	10
Obstruction - resolved	Barrier - Fencing, wall or other	143	154	59
Obstruction - resolved	Electric fence	44	26	7
Obstruction - removed	Fallen Tree	269	316	214
Obstruction - resolved	Locked Gate	6	4	
Obstruction - resolved	Ploughing and Cropping	113	77	44
Other	Delivery of materials	20	29	23
Other	Miscellaneous issues resolved	163	155	69
Stile	Installed or repaired	177	216	103
Stile	Stile To Gap	22	13	10
Stile	Stile To KG	39	48	13
Stile	Stile To PG	62	55	1
Terrain	Bank Steps	12	6	2
Terrain	Path Surface problem resolved	55	88	37
Waymark Post	Installed/Repaired	167	230	93
Issues Signed off		2071	2451	1069
Improvements	To aid mobility access	202	279	84
5% Survey Results	Paths Rated easy to use	75%	74%	74%
5% Survey Results	Structures rated easy to use	94%	93%	93%
5% Survey Results	Routes with Roadside Signs	94%	93%	93%
Number on Database	No. of issues os 31/03/12	799		
Number on Database	No. of Issues os 31/03/16	1531		
Number on Database	No. of Issues os 31/03/17	1114		
Number on Database	No. of Issues os 31/03/18	1498		
Number on Database	No. of Issues os 31/03/19	1740		
Number on Database	No. of Issues os 31/03/2020	2450		
Number on Database	No. of Issues os 31/03/2021	3100		
Number on Database	No. of Issues os 31/03/2022		3199	
Number on Database	No. of Issues os 19/10/2022			3402
Priority A issues	No of Issues recd/dealt with	212/182	187/184	105/115
Priority B/C issues	No of Issues recd/dealt with	2337/1709	2104/2076	1109/860
Priority D (low)	No of Issues recd/dealt with	142/107	168/110	107/49

**Above includes****Volunteer Jobs Completed**

Clearance direct from BCC	61/20km	137/10.3km	23/4km
Miscellaneous Jobs	9	16	16
Waymarking and signs	59	222	80
Gates Repaired and installed	4	77	27
Bank Steps			
Stiles replaced and repaired	18	21	9
Trees removed	17	13	7
<b>Total Jobs</b>	<b>168</b>	<b>486</b>	<b>162</b>

This page is intentionally left blank



## BUCKINGHAMSHIRE LOCAL ACCESS FORUM

# Report

---

### AGENDA ITEM 6

**Date:** 2<sup>nd</sup> November 2022

**Title:** LAF members' report

**Author:** Jonathan Clark, Strategic Access Officer

**Contact Officer:** Harry Thomas [01296 585234]

#### 1. KBI Flexi-pave [Gavin Caspersz]

Following the KBI Flexi-pave presentation at the July 2022 meeting, Gavin Caspersz will arrange a display of samples to view during the 11am tea break.

#### 2. Ridgeway Delivery Group meeting 14<sup>th</sup> September 2022 [Brian Worrell]

a] Signage – the overall message proposed was '*respect all users*', with preference for '*Be Nice, Say Hi*' slogan, developed by Cycling UK, along with '*Leave no Trace*'.

b] Grant funding 22/23 – proposed to be targeted on gates, benches and vegetation clearance where it improves access.

c] Grant funding 23-253 Targeted on surfacing: e.g. World Heritage sections, Ivinghoe Beacon and Chequers [Ellesborough]. Any other ideas, please email: [sarah.wright@Oxfordshire.gov.uk](mailto:sarah.wright@Oxfordshire.gov.uk);

d] Ridgeway 50<sup>th</sup> Anniversary [2023] has a dedicated website [The Ridgeway National Trail 50th anniversary](#); focussing on the top 50 places to visit and is aimed at new audiences. Any areas that don't show the Ridgeway in a good light?

#### 3. Great Missenden Train Station: Disabled Access

The LAF were consulted in March 2022 by Network Rail on the desirability of installing a lift and ramps to link north and south-bound platforms at Great Missenden station. The existing connection for disabled and push chair users is outside the station along a steep and longer alternative path. The chairman wrote in support of the application on 7<sup>th</sup> March 2023. We have now heard from Chiltern Railways' Stakeholder Manager to say the application to Network Rail was ultimately delayed from Spring 2022 to September 2022 and they anticipate an answer from Network Rail in early 2023.

**4. Opening of the new Berryfields to Buckingham Park Cyleway**

Richard Jennings has inspected this new route and attended the opening ceremony. Richard to provide a summary Appendix C.

**5. West End Road, High Wycombe - Public Spaces Protection Order**

Members may recall voting at the July 2022 meeting supporting the above order which closes Footpath HWU/80/1 for a further 3 years to combat anti-social behaviour. On 5th October 2022, the Deputy Leader and Cabinet Member Health and Wellbeing, on behalf of the Leader of the Council, extended the order for a further three years commencing 10th October 2022.

Cllr. Lesley Clarke and other LAF members enquired if it was possible to extinguish the footpath permanently to avoid repeating the process every 3 years. In answer to that question, a summary is provided by the rights of way team in Appendix D

**6. LAF Annual report 2021/22**

Enclosed for comment and final approval [Appendix E].

**7. Venue and dates of next meetings**

Paralympic Room, The Gateway, Gatehouse Rd, AYLESBURY HP19 8FF -  
*10am, 1st March 2023; 12th July 2023, 1st November 2023.*

# Berryfields to Buckingham Park Greenway

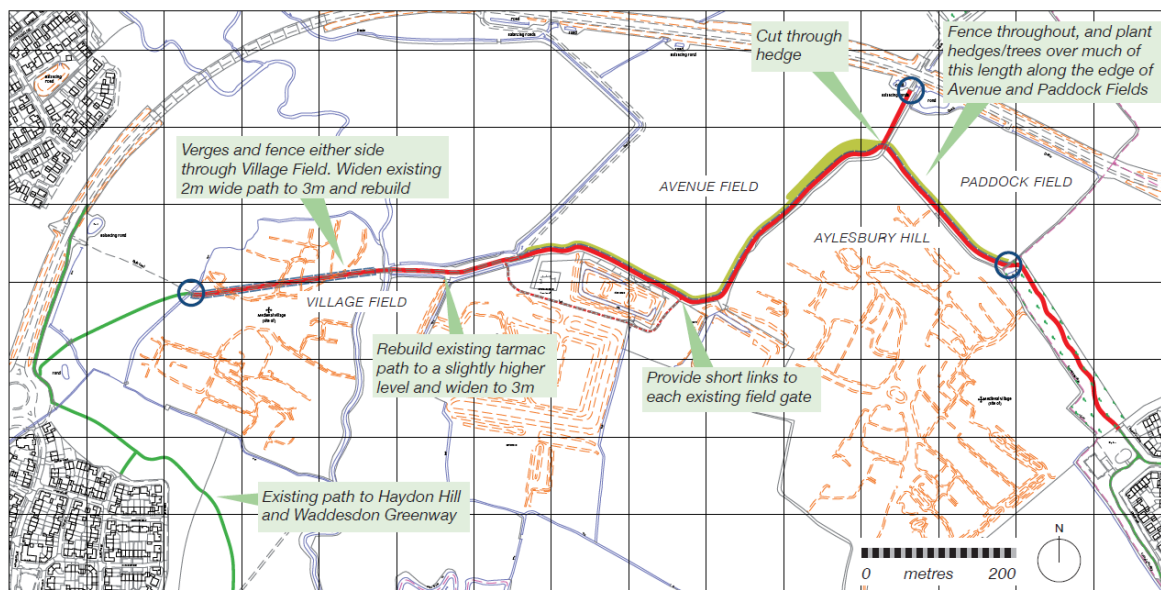
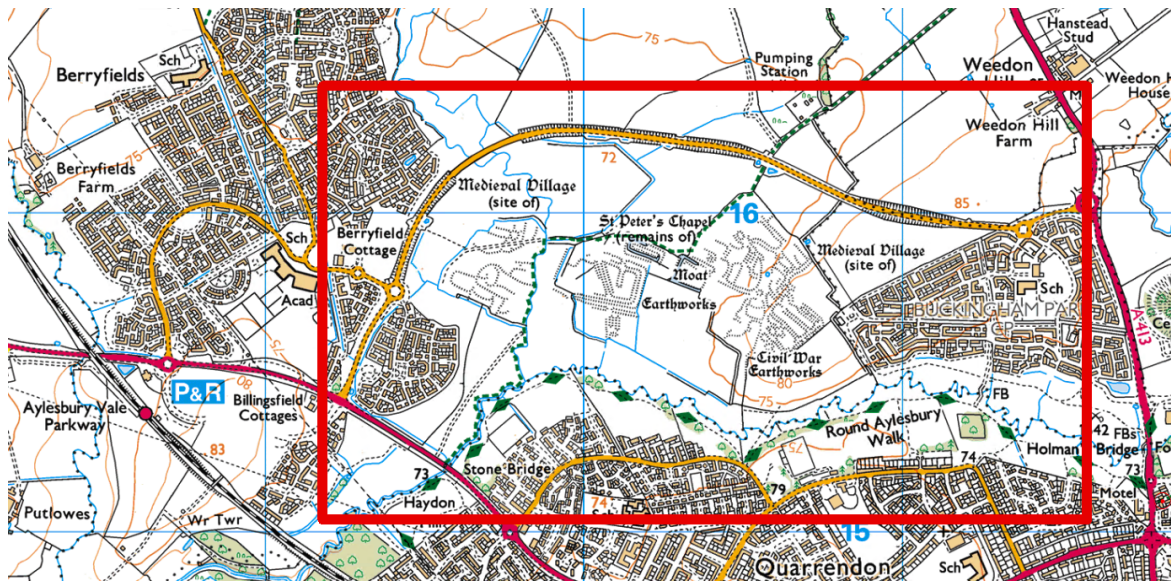

Berryfields and Buckingham Park linking path showing the Aylesbury Gardenway and existing paths

- Existing paths
- Proposed link
- Entrances to Trust lands

This page is intentionally left blank



### Proposed deletion of Footpath HWU/80/1 – West End Road, High Wycombe

Discussions have been held internally between the Definitive Map team and Rights of Way Operations teams about the above proposal and we have concluded that we should continue with the current Public Spaces Protection Order which is the most appropriate use of legislation for this issue.

A complete extinguishment of the route can only be achieved under s118 Highways Act 1980, and this will only succeed if it can be clearly demonstrated the route is not needed for public use. The legislation is very clear on that: reasons of anti-social behaviour cannot be taken into account. As the route is currently closed under a PSPO, it cannot be demonstrated that it is not needed for public use as the public have no choice but to not use it. The route would have to be reopened whilst the Order ran its course – which would most likely subject the residents to anti-social behaviour throughout. However, even if the route was reopened, we are still not convinced the legal tests would be met. The route is a through-route and connects with the wider PROW network. It provides a short cut, which could be beneficial to those less able bodied as opposed to the roadside footway. Proving it is not needed for public use is going to be far from easy.

The general theory behind a PSPO is that it allows time for miscreants to leave the area and criminality to reduce. If the wider area was to redevelop as maybe the case, this may drive the anti-social behaviour away. Once a PROW is extinguished, it is gone for good. Whereas the issues that are occurring along the route may only be temporary. It would seem unfair to seek full closure of a public highway for something which may be overcome over time.

It is therefore our view that the PROW remains closed under a PSPO and the situation reviewed as and when the Order expires. PSPOs are available for this very reason – to combat anti-social behaviour, but not to the long-term detriment of wider public access.



Plan of HWU/80/1 highlighted pink

This page is intentionally left blank

## Buckinghamshire Local Access Forum Annual Review 1<sup>st</sup> April 2021 – 31<sup>st</sup> March 2022

**Chairman** - *Richard Pushman*

**Vice-chairman** - *David Briggs*

**Meetings** - *14<sup>th</sup> July 2021; 3<sup>rd</sup> November 2021; & 2<sup>nd</sup> March 2022*

### **Member interests and organisations [14]**

- *Country Land & Business Association*
- *Buckinghamshire Conservation Trust*
- *National Trust*
- *British Horse Society*
- *Ramblers*
- *British Driving Society (Beds, Bucks & Herts)*
- *Cycling UK*
- *Disabled Ramblers*
- *Trail Rider's Fellowship*
- *Chiltern Society*
- *Buckinghamshire Council - Cabinet Member Transport*
- *Buckinghamshire Council - Member For The Risboroughs*
- *Parish councils*
- *Independent*

### **Meeting Diary**

All meetings are held at 10am in the Paralympic Room, The Gateway, AYLESBURY HP19 8FF. They can be attended in person or remotely having contacted the secretary in advance.

Dates of next meetings: 13<sup>th</sup> July 2022, 2<sup>nd</sup> November 2022, 1<sup>st</sup> March 2023, 12<sup>th</sup> July 2023 and 1<sup>st</sup> November 2023.

### **Guest Speakers**

Members welcomed the following speakers:

- Sarah Wright, Ridgeway National Trail Officer;
- Ben Feeney-North, Transport Strategy Officer, Bucks Council;
- Hannah Joyce, Transport Strategy Lead Officer, Bucks Council; and
- Nicola Thomas, Natural Environment Partnership Manager

Regular observers also attend from the British Horse Society and Chiltern Society.

### **Monitoring success**

The regular business of Local Access Forum includes updates from definitive map, strategic access and operations teams, with reports provided respectively in that order. Members provide feedback and questions, through which progress, workloads and priorities are monitored.

### **Advice**

The forum provided advice on the following:

1. The Buckinghamshire Cycleway following HS2;
2. ROWIP Action Plan [Year-1 Report];
3. Bacombe Hill SSSI bridleway works in Wendover [site visit];
4. The Buckinghamshire Natural Environment Partnership;
5. Local Transport Plan 5;
6. Buckinghamshire council's Byway Prohibition Order Permit Scheme;
7. Buckinghamshire council's Rights of Way Enforcement Policy 2021; &
8. Ridgeway Riding Route Wendover off-road cycling audit report.

### **Open Access Land advice**

The Forum provided the National Trust with informal advice on their ash die-back tree works on West Wycombe Hill. In addition, advice was provided to Natural England on open access restrictions at Wayside Farm and Chawley Manor Farm, Bledlow. This resulted in changes to the original proposals to the benefit of walkers.

### **National Government**

The Forum wrote to the Rt Hon Michael Gove MP, Secretary of State for Levelling Up, Housing and Communities, with concerns about the slow progress of Definitive Map Modification Orders referred to the Planning Inspectorate for determination. They also lobbied for an extension of the 2026 cut-off date for submission of Definitive Map Modification Orders.

### **Improving public access: making a difference**

Members are involved in following voluntary activities:

1. publishing and leading walks in the Chilterns;
2. surveying promoted routes and completing BVPI reports;
3. trouble-shooting new cycling and walking routes;
4. attending Ridgeway Delivery Group meetings;
5. lobbying HS2 to address impacts of construction on equestrians; and
6. making DMMO applications.

## **The Rights of Way Improvement Plan 2020-2030**

Members provided advice and feedback on the draft Year-1 report

### **Scrutiny**

The LAF provides independent strategic oversight of the council's public access work across the county, which has multiple positive outcomes for public access.

Regular bi-annual BVPI-type surveys provide 'Easy to Use' scores and every meeting is provided with a maintenance and improvement summary and major bridge / surfacing schemes for members to monitor progress.

### **Comments from the appointing authority**

LAF advice is valued greatly and we are fortunate to have members with a broad range of countryside experience and knowledge. This results in balanced advice, without any particular interest group dominating. Numbers continue to remain good at 14.

Members challenge and scrutinise the council and speakers. In this way the forum holds the council to account. At the same time, members understand pressures from increasing workloads and residents' high expectations.

### **Comments from the Chairman**

This concludes my fourth and final annual report as chairman.

Our meetings are conducted in good spirits from members demonstrating a great interest and passion for access in our county. Thank you to everyone for your attendance and support throughout my tenure as chairman.

I am also very grateful to Buckinghamshire council for providing a meeting venue, secretariate support, funding and cabinet member appointments.

I would also like to thank our rights of way officers for their commitment to improving access and maintaining high standards, against a background of significant growth and infrastructure pressures.



**Richard Pushman (Chairman)**

This page is intentionally left blank